



# F2B and S2S MITTERS INSTALLATION MANUAL

Part # MTRRF360 [...] and MTRRS360 [...]

(ALL COLORS)

## Equipment Features

- Aluminum Structure Color Skinz™ Snap On Structure Wrap
- 4 Baskets over-lapping design offers seamless cleaning coverage
- Over lapping baskets eliminates “skunk stripe possibilities
- Less Than 8 Feet of Tunnel Space required
- 10 Feet (120”) Overall Height
- Easy to replace “Looped” style cloth

## Equipment Specifications

	FRONT-TO-BACK MITTER MTRRF360 [...]
TUNNEL LENGTH	84”
TUNNEL WIDTH	144”
UNIT HEIGHT	120”
VEHICLE CLEARANCE	90”
ELECTRICAL	MOTOR: 1.5 HP-3 PH 6.6-3.0 AMPS/208-460 VAC
PNEUMATICS	N/A
WATER	RECLAIMED OR FRESH: 4 GPM @ 40 PSI

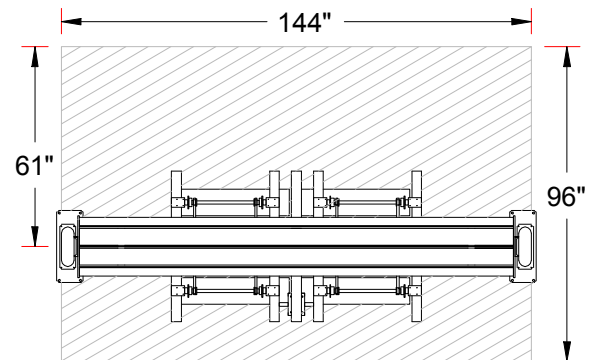

Pic #1 F2B Mitter Working Envelope

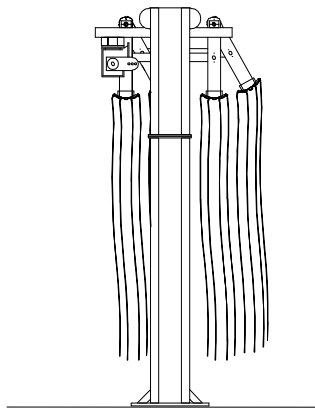

Pic #2 F2B Elevation View

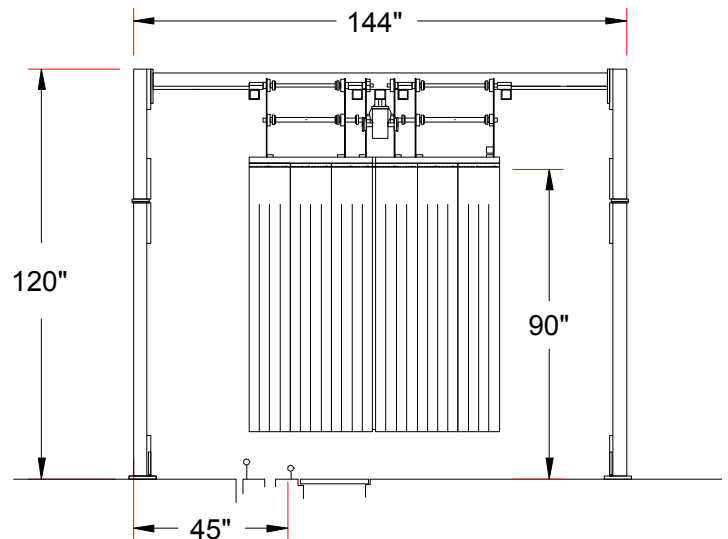

Pic #3 F2B Mitter Dimensions

	<b>SIDE-TO-SIDE MITTER MTRRS360 [ . . . . ]</b>
<b>TUNNEL LENGTH</b>	<b>84"</b>
<b>TUNNEL WIDTH</b>	<b>144"</b>
<b>UNIT HEIGHT</b>	<b>120"</b>
<b>VEHICLE CLEARANCE</b>	<b>90"</b>
<b>ELECTRICAL</b>	<b>MOTOR: 1.5 HP-3 PH 6.6-3.0 AMPS/208-460 VAC</b>
<b>PNEUMATICS</b>	<b>N/A</b>
<b>WATER</b>	<b>RECLAIMED OR FRESH: 4 GPM @ 40 PSI</b>

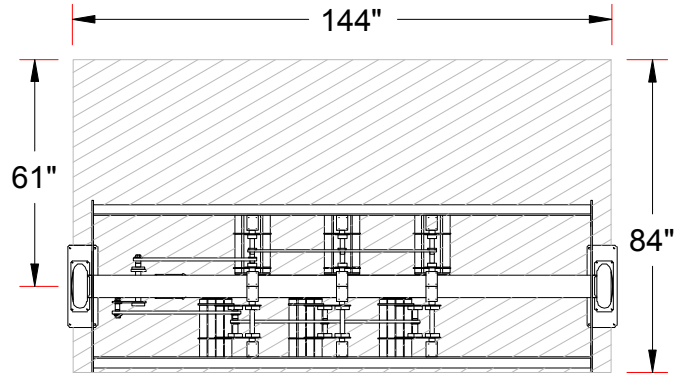

**Pic #4 S2S Mitter Working Envelope**

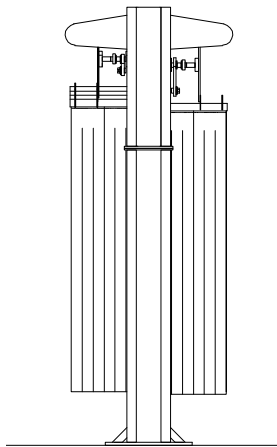

**Pic #5 S2S Elevation View**

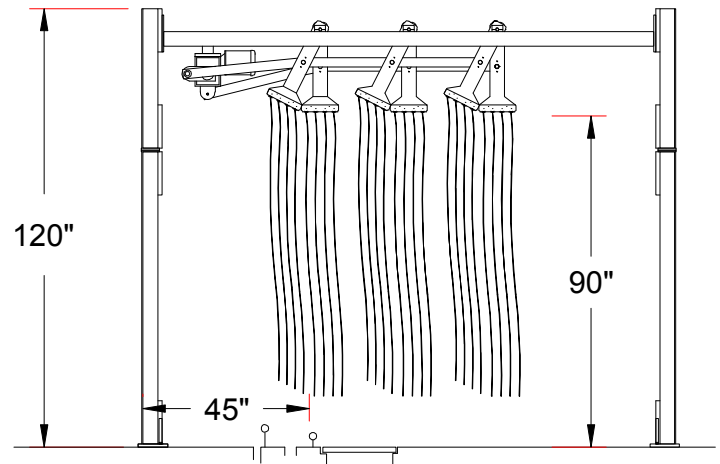

**Pic #6 S2S Mitter Dimensions**

## TABLE OF CONTENT

Equipment Features .....	Page: 1
Equipment Features .....	Page: 1
Table Of Content .....	Page: 2
Suggested Tools and Installation Materials .....	Page: 3
Installation Instructions .....	Page: 3
Plumbing Installations .....	Page: 7
Electrical Installations .....	Page: 7
Start-Up Procedures .....	Page: 9

## Suggested Installation Tools and Materials

- |   |                                  |                          |                                   |
|---|----------------------------------|--------------------------|-----------------------------------|
| <input checked="" type="checkbox"/>  | Hammer Drill with 5/8" Drill Bit | <input type="checkbox"/> | (12) Wedge Anchor Bolts 5/8" x 6" |
| <input type="checkbox"/>  | Sledge Hammer                    | <input type="checkbox"/> | Safety Goggles                    |
| <input type="checkbox"/>  | Set of Standard Combo Wrenches   | <input type="checkbox"/> | Torpedo Level                     |
| <input type="checkbox"/>  | Measuring Tape                   | <input type="checkbox"/> | Pry-Bar                           |
| <input type="checkbox"/>  | 6' Step Ladder                   | <input type="checkbox"/> | 1/2" Polyflow Tubing              |

## Notes and safety Symbols

Where necessary, important points will be highlighted in this manual, using the following symbols:



**NOTES:** PROVIDES FURTHER INFORMATION!



**STOP!** PRECAUTION TO TAKE TO AVOID EQUIPMENT MALFUNCTION OR ERROR!



**WARNING!** DANGEROUS SITUATION WHICH MAY CAUSE EQUIPMENT DAMAGES, PERSONAL INJURIES OR FATALITIES!

**Always follow all "Notes", "Warning" and instructions. Not doing so may have serious consequences on the overall performance of the equipment and/or the safety of the people working on the equipment!**

## Installation Procedures

-  **Upon** receiving your MCWW equipment, open all boxes and crates and verify that you have all the required components as well as there are no damages to the equipment. Verify also that you have all your installation material.
- Remove** packaging material covering your **MCWW MITTER** and bring it to the wash in the area where it will be installed and verify that the area is sufficiently large for the **MCWW MITTER WORKING ENVELOPE** and **DIMENSIONS** (see Picture #1 though #6).

- Remove the **MITTER** off the shipping crate with a **FORK LIFT TRUCK** and secure the **MITTER HEAD ASSEMBLY** to the forks.



**WARNING!**  
**STRAP MITTER HEAD ASSEMBLY SECURELY TO THE FORKS BEFORE RAISING THE EQUIPMENT**

- Raise the **HEAD ASSEMBLY** above the height of the support legs. Remove the legs from the shipping crate and dispose of the crate. Bring the **SUPPORT LEGS** under the **HEAD ASSEMBLY** and secure to the mount plates (see Picture #7 below). After the legs are secured to the head assembly, position the **BACK of the DRIVER SIDE LEG 45" AWAY FROM THE INSIDE EDGE OF THE INSIDE GUIDE RAIL** (see Picture #7 below). Secure the driver side leg to the floor using **ONE 5/8" ANCHOR BOLT**.

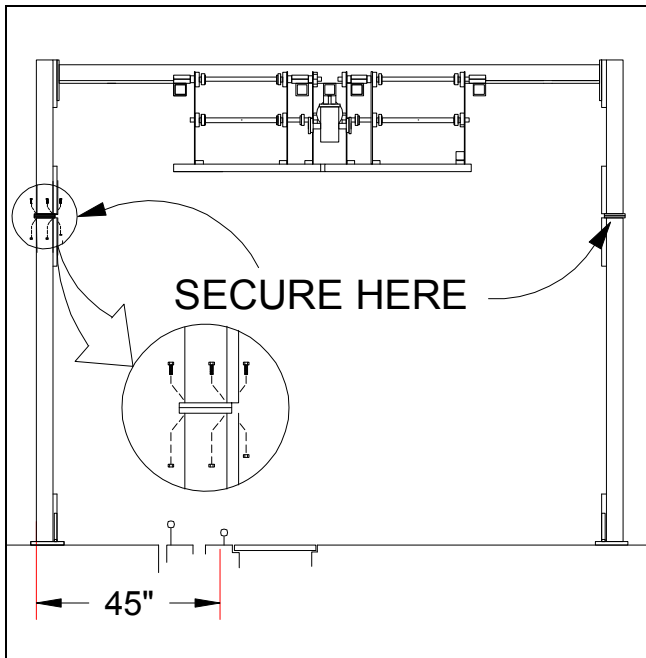

Pic #7 Mount the Legs

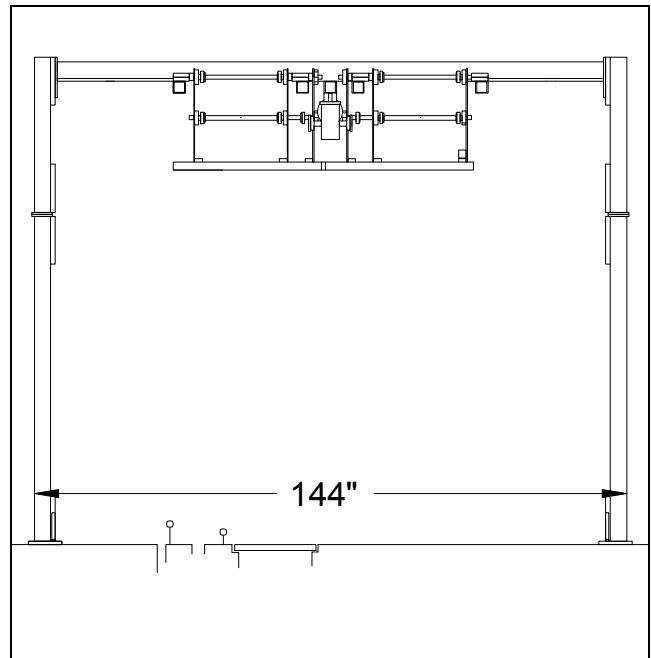

Pic #8 Distance Between Legs

- Square the **MITTER** with the conveyor and verify that the **BACK OF THE PASSENGER SIDE LEG** is located **ABOUT 144" AWAY FROM THE BACK OF THE DRIVER SIDE LEG** (see Picture #8).
- Secure the passenger side leg with **FOUR 5/8" X 6"L ANCHOR BOLTS**. Secure the driver side leg with three additional anchor bolts.
- Open the box containing the cloth. Remove the mitter basket end cap (see Picture # 9), slide out the rod about 12 to 18" and then slide a piece of wash cloth thru the rod (see picture #10). Push the cloth into the basket receiver. Repeat until the basket is filled. Reinstall the end cap.



**48 PIECES WILL BE REQUIRED FOR A COMPLETE S2S MITTER**



**64 PIECES WILL BE REQUIRED FOR A COMPLETE F2B MITTER**

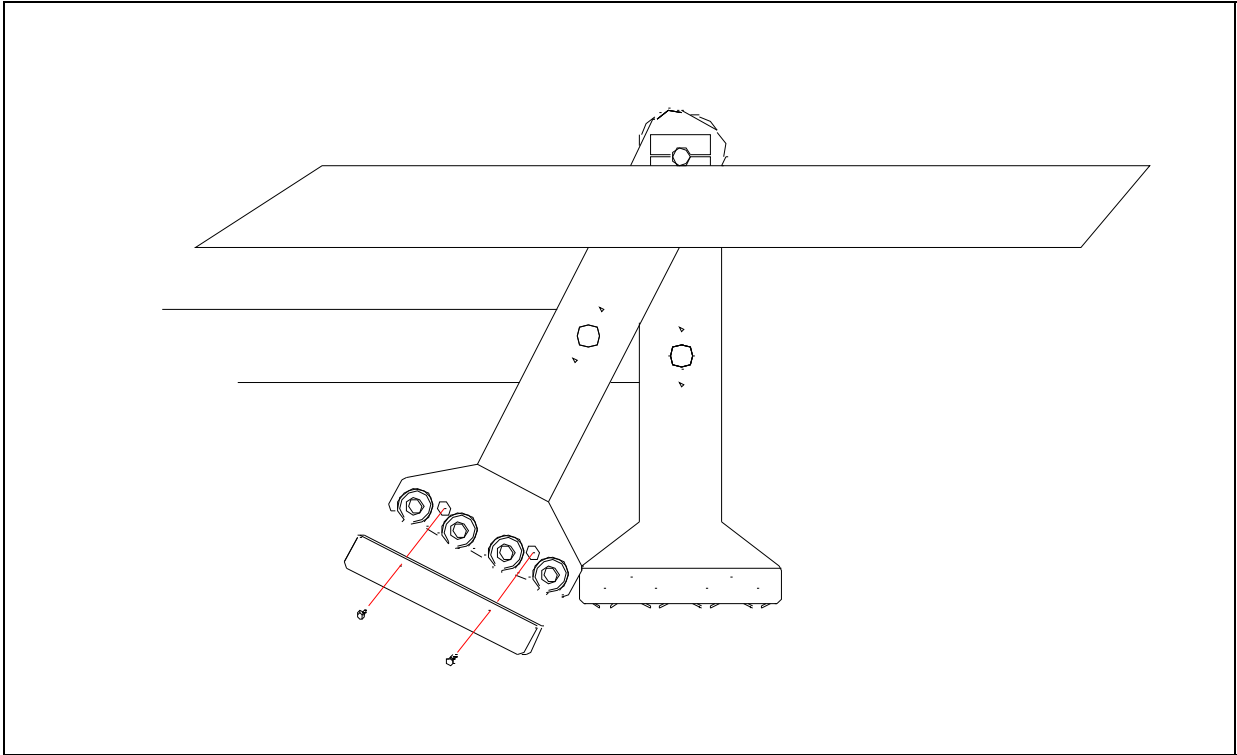

**Pic #9 Basket End Cap**

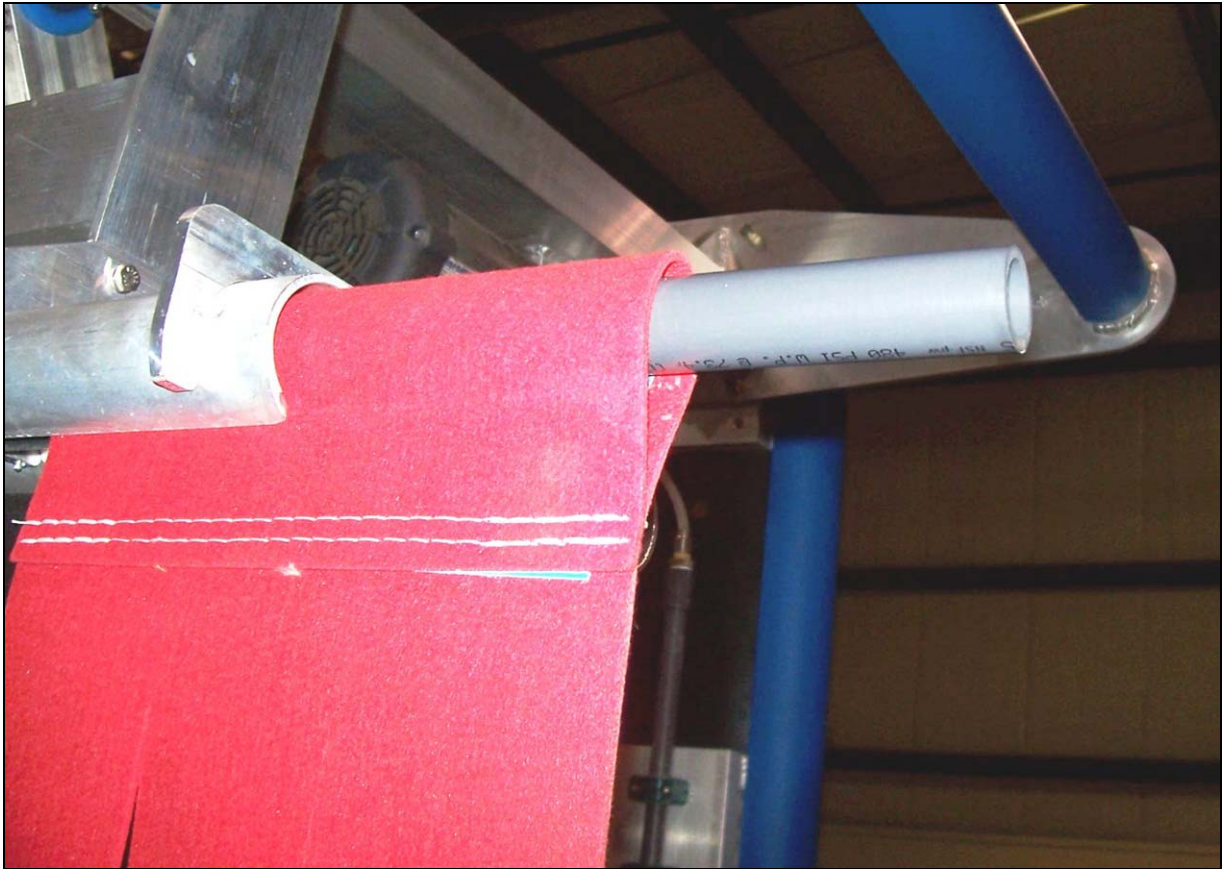

**Pic #10 Looped Cloth**

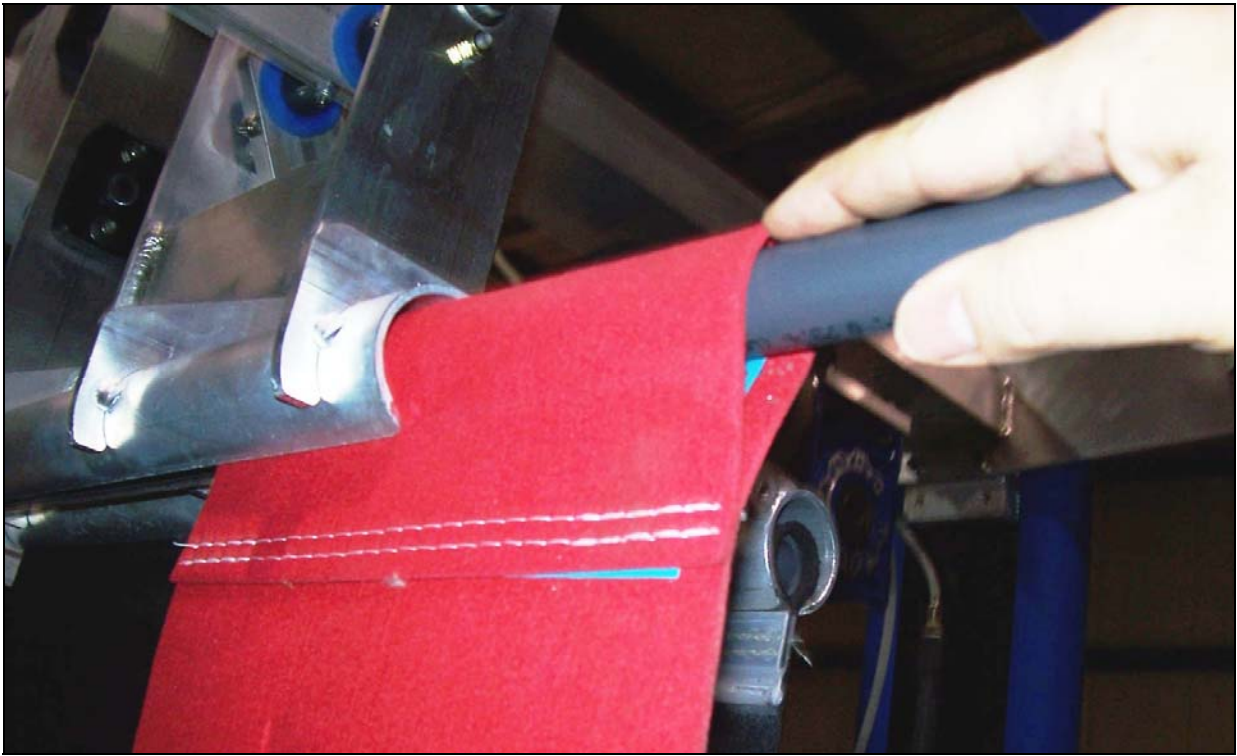

Pic #11 Slide Cloth into Basket Receiver

## Color Skinz™ Wrap Installation

- ☐ **Locate** the boxes containing the **COLOR SKINZ™** wraps and install on each legs and frame cross beams.



Pic #9-A Color Skinz™

SELECT THE PROPER COLOR SKINZ™ COVER. SNAP ONE SIDE OF THE LIPS, SLIDE THE COVER AROUND THE LEG AND FINALLY SNAP THE SECOND LIP PASSED THE EXTRUSION EDGE (see Picture #9-B)

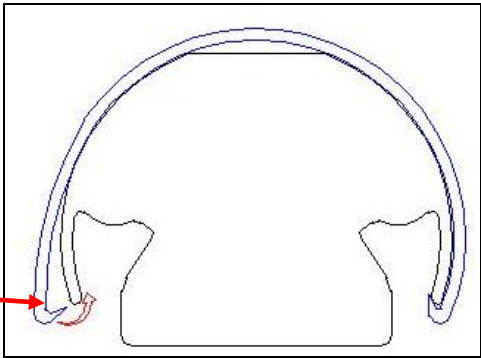

Pic #9-B Color Skinz™

## Water Supply Installation

- Connect** each mitter water manifold to a water source capable of at least 4GPM @ 40 PSI. Fresh or reclaimed water can be either used.

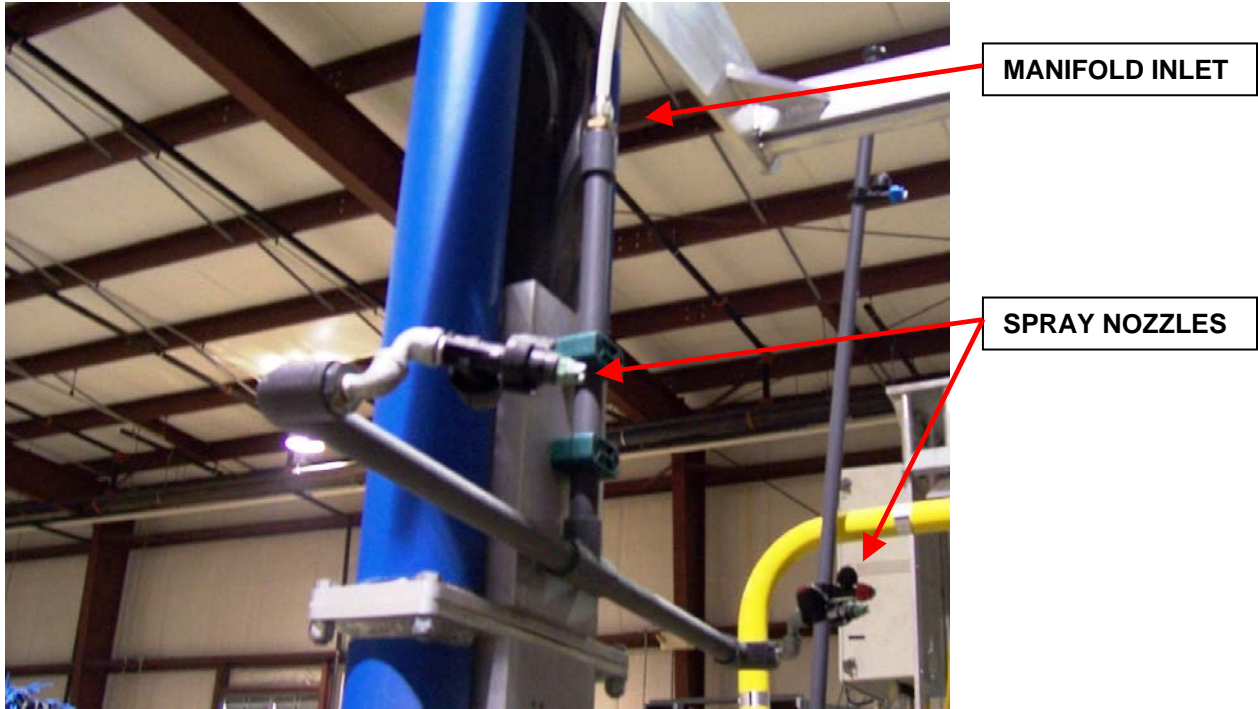

Pic #12 Water Manifold

## Electrical Installation

- Open** the motor connection box, and connect the **1.5HP MOTOR** following the diagram below (see Picture #13) for the voltage available at your site. The motor can operate at different voltages: **208, 230 or 460 VAC, 3 PH**. Connect to a starter unit, protected by an **OVERLOAD RELAY SET AT THE MOTOR RATED FULL LOAD CURRENT FOR THE PROPER VOLTAGE** (see Picture #14).

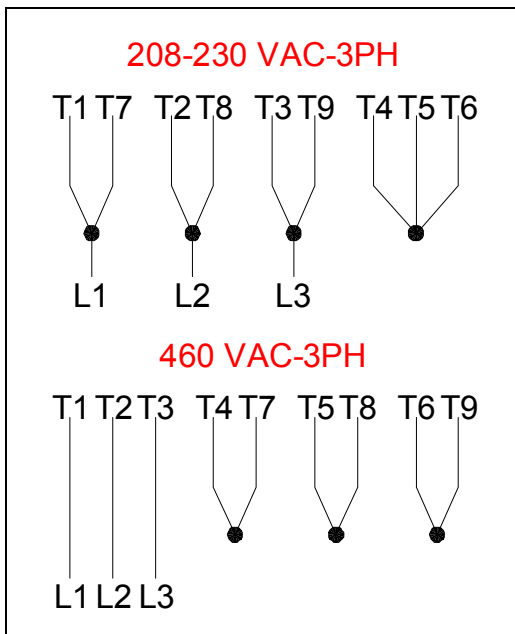

Pic #13 Motor Wiring Connection



**WARNING!**

**THE MOTOR HAS TO BE PROTECTED WITH AN OVERLOAD RELAY SET AT THE MOTOR RATED FULL LOAD CURRENT FOR THE PROPER VOLTAGE:**

**6.6 AMPS @ 208 VAC - 3PH**  
**6.0 AMPS @ 230 VAC - 3PH**  
**3.0 AMPS @ 460 VAC - 3PH**

Pic #14 Motor Full Load Current

- You may also use an **INVERTER UNIT** to run the **MITTER MOTOR**. If you are using **A MOTOR CITY WASH WORKS INVERTER BOX**, the only available voltage for the inverter box is **208VAC-3PH**.



**WARNING!**  
**CONNECT YOUR MOTOR CITY WASH WORKS INVERTER BOX TO 208VAC-3PH ONLY!**  
**DO NOT CONNECT TO 460VAC-3PH**  
**MAJOR DAMAGES WILL OCCUR TO YOUR INVERTER UNIT!**

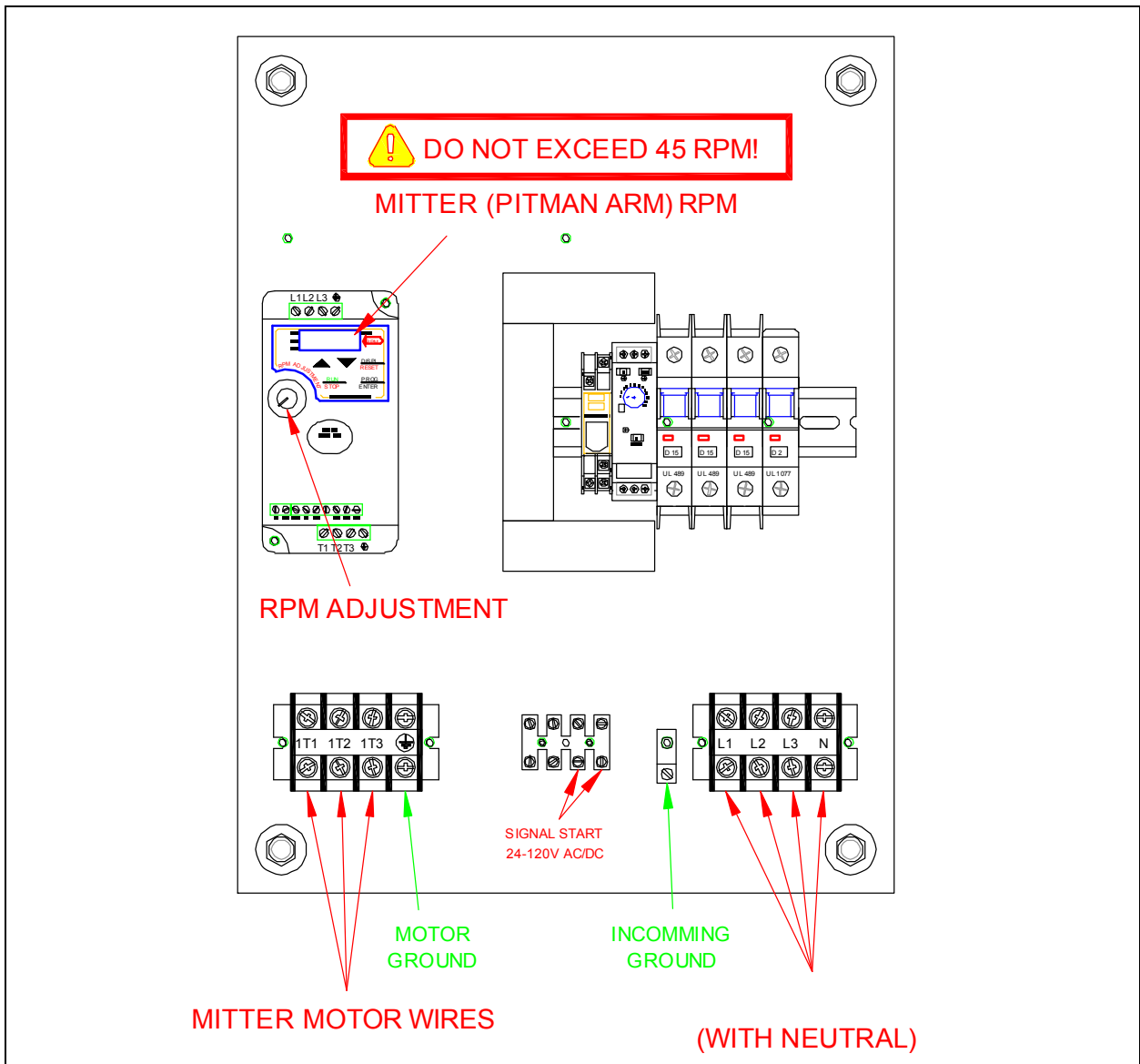

Pic #15 Motor City Wash Works inverter Unit

## Start Up Procedure:

- Turn the **MOTOR ON** and verify proper operation of the mitter. If you are using an inverter unit to operate the motor, set the speed to desired level.



**WARNING!**  
**DO NOT RUN THE MITTER AT SPEED EXCEEDING  
45 RPM!**  
**MEASURE SPEED AT THE GEARBOX PITMAN ARM  
RUNNING THE MITTER AT HIGHER SPEED MAY DAMAGE  
OR WEAR PREMATURELY THE DRIVE MECHANISMS**

- While** the motor is still running, Turn the water ON and adjust the nozzle to spray in the direction of the cloth.
- Test** a vehicle.

## Warranty and Return Procedure:

**Motor City Wash Works** warrant this product to be free of defect in material and/or workmanship for a period of **one year** from the date of the purchase by the customer from MCWW. During the warranty period MCWW will at its discretion, at no charge to the customer, repair or replace this product if found defectives, with a new or refurbished unit, but not to include costs of removal or installation. Any product returned to MCWW for warranty has to have a **Return Material Authorization Number**. All shipping cost to MCWW is assumed by the customer. This is only a summary of **MCWW Limited Warranty**. Please, communicate with MCWW for our complete warranty. **Prior** to returning any product to MCWW, the customer must call in for **Return Material Authorization Number** and a copy of our **Return Material Authorization** Form filled and completed. The **RMA** number must be written clearly on the outside of the shipping package and copy of the form must be included in the package.